

CLOCKTOWN MAIL-BOX INSTRUCTIONS

step 1



This mailbox stand is not a very difficult model, so you probably won't need many tools. I do recommend a thick piece of cardboard as sturdy bottom, though.

step 2

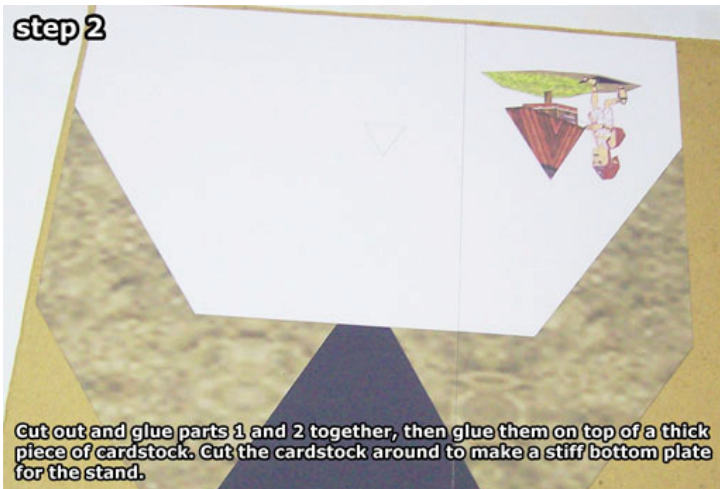

Cut out and glue parts 1 and 2 together, then glue them on top of a thick piece of cardstock. Cut the cardstock around to make a stiff bottom plate for the stand.

step 3

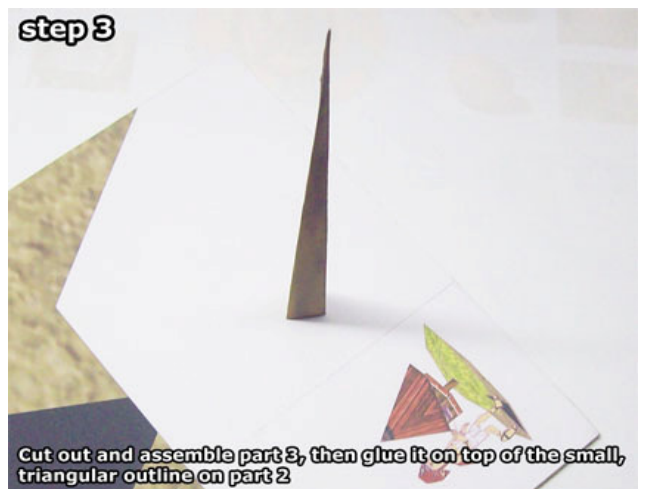

Cut out and assemble part 3, then glue it on top of the small, triangular outline on part 2

step 4

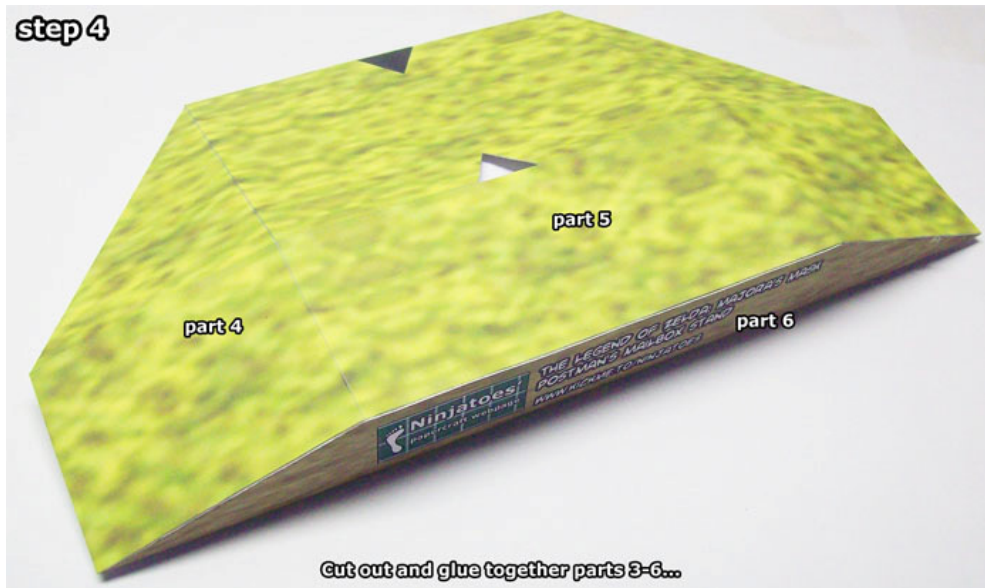

Cut out and glue together parts 3-6...

step 5

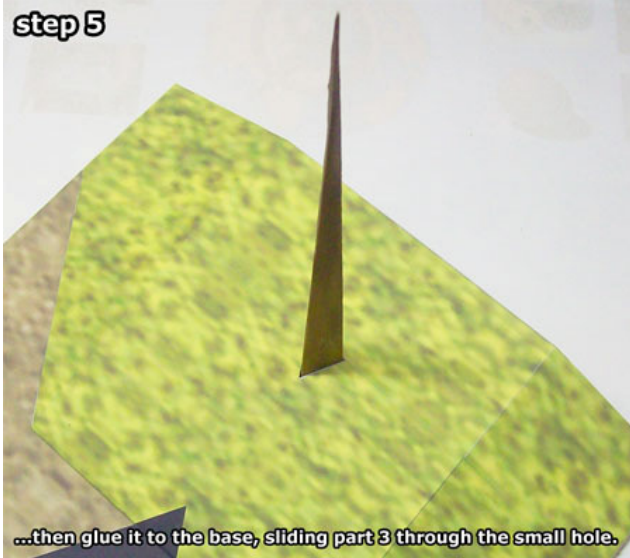

...then glue it to the base, sliding part 3 through the small hole.

step 6



Glue together parts 7 and 8...

step 7



...then assemble and glue on parts 9 and 10.

step 8



The next part to glue on is part 11: align the box with the rectangle on part 11, making sure the pointy side is on front as shown here.

step 9

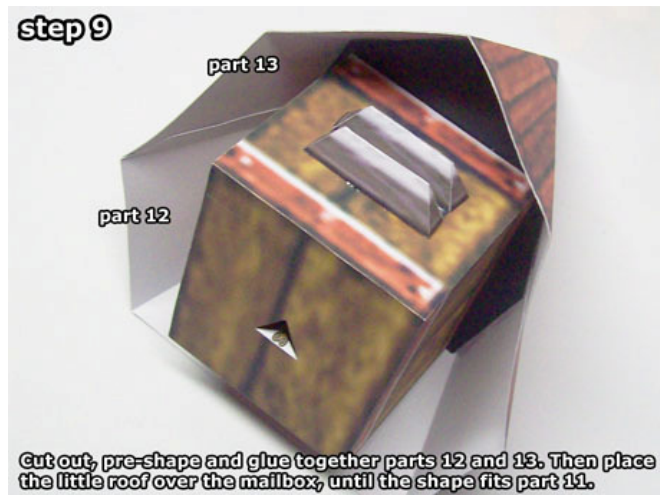

Cut out, pre-shape and glue together parts 12 and 13. Then place the little roof over the mailbox, until the shape fits part 11.

step 10



Now gently slide the mailbox over the pole (part 3) using the holes. Use glue if you want to.

step 11



Now the Postman has somewhere to deliver his letters! ;o)

Thank you for building a Ninjatoes' papercraft model!
www.kickme.to/ninjatoes