

SKYWARD SWORD IMPA (YOUNG)
INSTRUCTIONS

step 1

glue
toothpick
X-Acto knife
rubber cutting mat

parts (printed on 200 gsm paper)

SKYWARD SWORD IMPA (YOUNG)
The character of Impa appears in several games and movies, often as an older woman who is the guardian of Princess Zelda. The Impa in Skyward Sword is especially a strong, athletic woman of the Sheikah tribe, who seems to know much about the events and locations surrounding the goddess Hylia, Hyrule, and the land below.
*Please use hot glue. Look out for ants on the glue and stop the ant! Education who gives us more the Skyward King. Thank you!

To build your own papercraft Impa, you need the parts (preferably printed on thicker paper), a sharp knife, glue, and any other tools that you find might be useful! ;o)

step 2

part 2
part 1

Pre-shape* and assemble parts 1 and 2...
*www.tinyurl.com/preshaping

step 3

...and then glue them together like so.

step 4

part 3
Do the same for part 2...

step 5

...and finally part 4.

step 6

part 5
Glue part 5 to the bottom of the head.

step 7

part 7
part 6
Glue together parts 6 and 7 as shown here.

step 8

part 8
Then glue on part 8...

step 9

parts 6-11
parts 12-17

...and the other three parts (9-11) of the right leg. Do the same for the other leg (parts 12-17).

step 10

part 18
Pre-shape and assemble part 18 as shown here; first glue together the edge marked "A", and then fold over and glue on the bottom edges marked "B".

step 11



Next, glue parts 6-11 to part 18...

step 12



...do the same for the other leg (parts 12-17) and glue on part 19.

step 13



Glue together the two ends of part 20, and then slide it over Impa's waist (you don't have to glue it on).

step 14



Pre-shape and then glue on parts 21-26 to the side of Impa's waistband.

step 15



Pre-shape and glue together parts 27-30 as shown here.

step 16



Take your time to pre-shape part 31 as shown here...

step 17

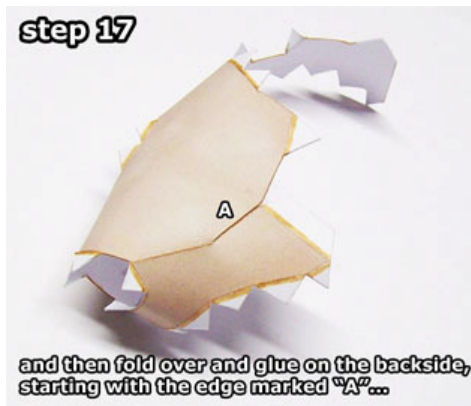

and then fold over and glue on the backside, starting with the edge marked "A"...

step 18



...and then the other side with the edges marked "B" and "C".

step 19



Take your time to shape and glue on part 31 inside parts 27-30 as seen here from the back...

step 20



...and here from the front.

step 21



Assemble and then glue part 32 on top of the torso.

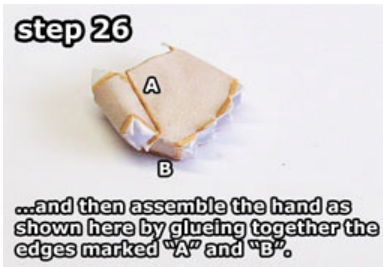

step 33

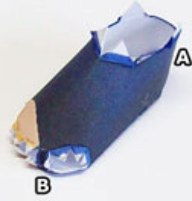

Assemble part 65 by first gluing together the back marked "A", then the sole, and then fold over and glue on edge marked "B".

step 34



Glue on parts 66 and 67.

step 35



Next, pre-shape, assemble and glue on the toes one by one just like the fingers.

step 36



Do the same for the other foot (parts 73-80). Then glue together the legs, the torso with arms, the head and the feet. Shape Impa's left arm to put her hand on her hip.

Thank you for building a Ninjatoes' papercraft model!
www.kickme.to/ninjatoes